

# PROJECT CASE STUDY

NOTTINGHAM

## OVERVIEW

This combination of **Series 3** platforms and 310m of **Speedscreen** made for an excellent solution for mounting equipment and screening off ductwork. Also included were two screened walkways for access between roof areas. The system utilized a ballast-weighted design, which meant that no roof penetrations were required during installation. This preserved the integrity of the waterproofing membrane and reduced the risk of leaks or long-term structural issues—an ideal solution for retrofits or sensitive roof structures.

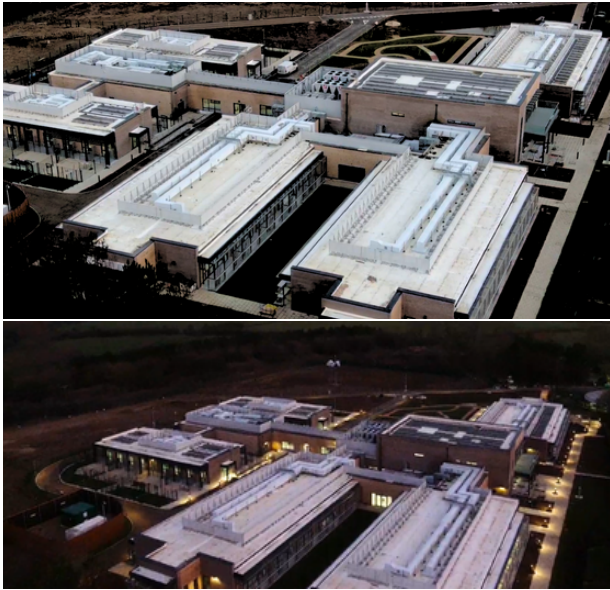

**CLIENT** - Henry Brothers LTD

**PRODUCT DESCRIPTION** - **Series 3** platform with 2.5m high screens and door, **Series 3** platform with 1.7m high screens and door, **Speedscreens** with 1.2m high screens and doors, mesh walkway with **Guardrail**.

**MARKET SECTOR** - Healthcare

## KEY FEATURES

- **Series 3** platform for a secure, non-penetrating rooftop solution.
- Ballast-weighted **Speedscreen** for enclosing and protecting equipment without any roof penetrations.
- **Guardrail** system and access steps to ensure safety for maintenance teams.
- Conforms to **BS EN 516 2006** and **BS EN 1090-3 2008**

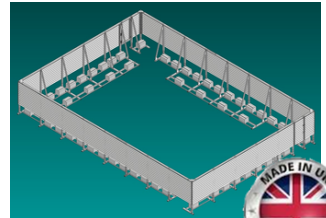
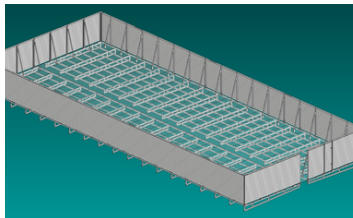
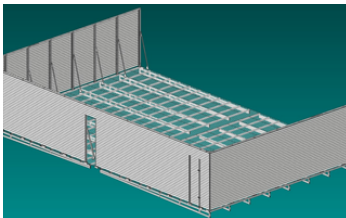

## COMPLETED PROJECT IMAGES



## INSTALLATION

The installation was successfully completed over a three-week period by a dedicated five person team. Thanks to the modular, prefabricated design and the inclusion of clear, easy to follow instructions, the process was highly efficient from start to finish. The pre-engineered components arrived onsite organized and ready for assembly, significantly reducing installation time and complexity. The modular concept played a key role in the project's success; ensuring there were no missing parts, no product waste, and no delays. This streamlined approach not only minimized onsite disruption but also enabled the team to complete the build smoothly and within the projected timeline.



## DESIGN

This low **Speedscreen** system was purposefully designed to hide unsightly air conditioning units and ductwork, ensuring a cleaner and more cohesive rooftop aesthetic. Spanning a whopping 453 metres all together, the screens not only delivered on visual impact but also on practicality. It was powder-coated to perfectly match the building's exterior, helping it blend seamlessly with the overall architectural palette.

Additionally, a **Series 3** platform was used to mount specific HVAC equipment. The platform featured a specialised 6mm cushioning tape applied to its base, creating a soft interface between the structure and the roof surface. This approach ensured that rooftop equipment could be securely supported without compromising the membrane, required no penetrations and reduced vibration.



See below QR codes to our Specification Sheets for all our products used in this job



Series 3

Click or scan



Speedscreen



Guardrail

ConfiguredPlatforms

