

# STANDARD SCREEN

Standard Screen aesthetically hides equipment, ductwork and pipework



## DESIGN

- Can be fitted to any sides of Series 1, 2 or 3 Platforms and to any 600mm increment from the corners.
- Clean straight lines for a tidy look.
- All aluminium components with stainless steel fixings – backed by a 20 year warranty.
- Standard Heights: 1200mm, 1600mm, 2000mm & 2400mm
- Aluminium slats 65x15mm placed at 80mm horizontal repeat pitch. Can be applied to top screen section only for parapet situations.
- Super lightweight 7kg/m<sup>2</sup>
- Free area: 18.75%
- Complies to BS EN 516 2006 and BS EN 1090-3 2008
- A1 fire rated / powder coated items A2 fire rated

## EFFICIENCY

- Kit form allows them to be assembled by a trade already on site with our easy to follow installation manual.
- Take the stress out of your project with our nationwide approved installer network.
- The lightweight aluminium design makes it easy for carrying, craning and assembly.

## SPECIFY CONFIGURED PLATFORMS

- Provide Standard Screen where aesthetically required to screen off equipment, ductwork, and pipework.

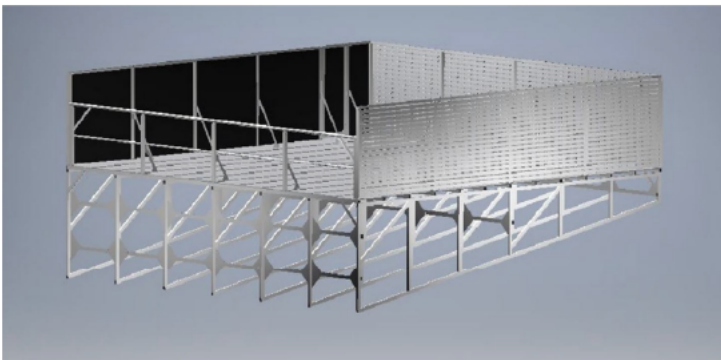

## OPTIONAL ACCESS GAP OR GATE

- An access gap of any 600mm increment wide is configurable in the Standard Screen.
- A Self Closing Access Door 600mm wide is configurable in the Standard Screen.
- A Self Closing Double Access Door 1200mm wide (2 x 600mm doors) is configurable in the Standard Screen.

## WIND LOADS

Standard Screen is suitable for regions A, B, C & D.

Pre-engineered factors: Terrain category, area wind velocity according to EuroCode 1, building height and screen height.

Basic mean hourly wind speeds:

- Region A - 22m/s
- Region B - 24m/s
- Region C - 25m/s
- Region D - 27m/s

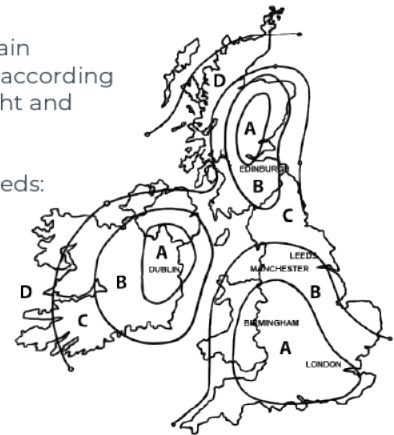

## SPECIFICATION

• Slat colours available in all RAL and BS colour ranges with polyester powder coat to 40 microns thickness.

• Materials: Grade 6063 T6 aluminium & A2 stainless steel fixings.

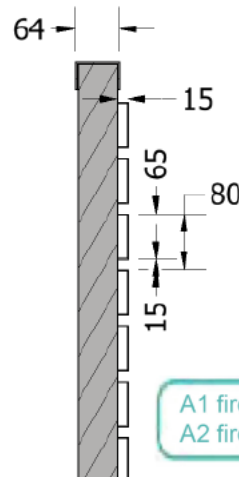

A1 fire rated/  
A2 fire rated

