

# SERIES 1

Assembly Instruction Manual

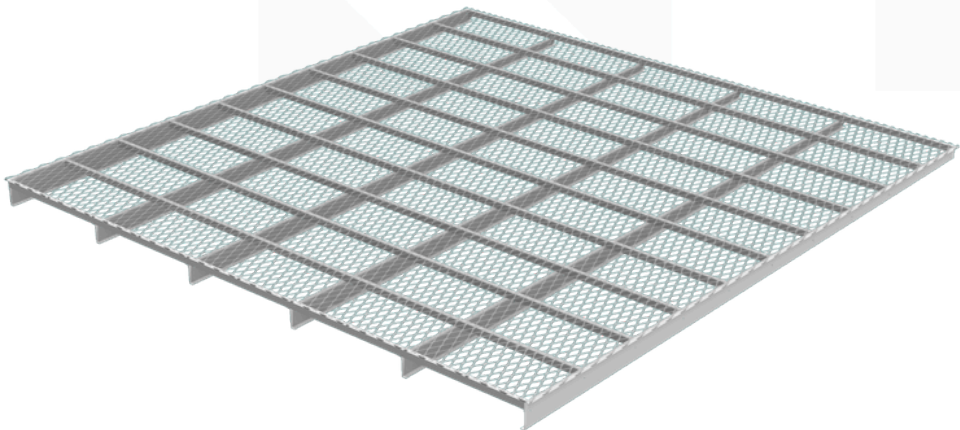

Configured**Platforms**<sup>®</sup>



Prefabricated plant enclosures & platform systems

 **value**engineering<sup>®</sup>

+44 (0)113 276 0450

[TechnicalSupport@configuredplatforms.co.uk](mailto:TechnicalSupport@configuredplatforms.co.uk)

[www.configuredplatforms.com](http://www.configuredplatforms.com)

# Configured Platforms<sup>®</sup>

 value engineering<sup>®</sup>

## SERIES 1

Low-Profile Surface Mounted Platforms-  
Ideal For Pitched Roofs

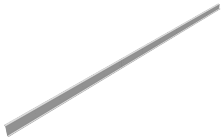

End Beam  
**Wedge Left**



Intermediate  
**Wedge**



End Beam  
**Wedge Right**



End Beam  
**Splice**



Intermediate  
**Splice**



RHS **Splice**



Intermediate  
**Bracket Left**



Intermediate  
**Bracing Bracket**



Intermediate  
**Bracket Right**

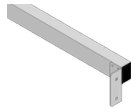

Cross **Support**  
with **End Bracket**

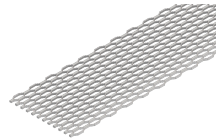

Mesh **Sheet**

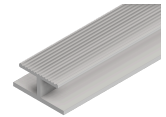

Mesh **Joiner**



20mm **Bolt Sets**



35mm **Tek Screw**  
+ **Hold Down Disc**



Certification Plate



20mm **Tek Screws**

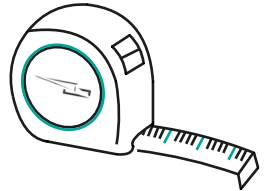
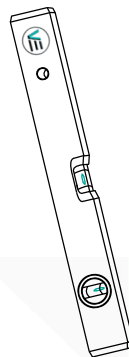
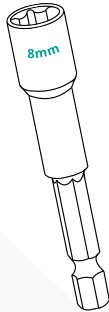
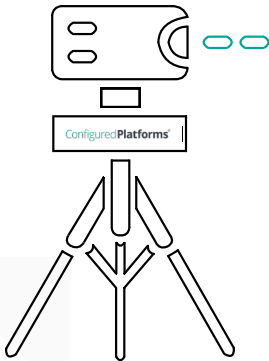
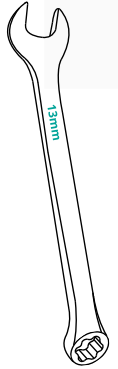
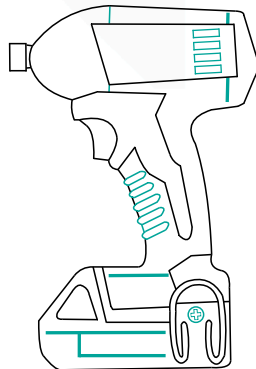
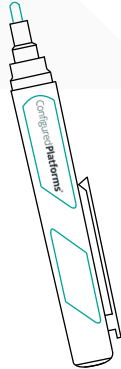

1

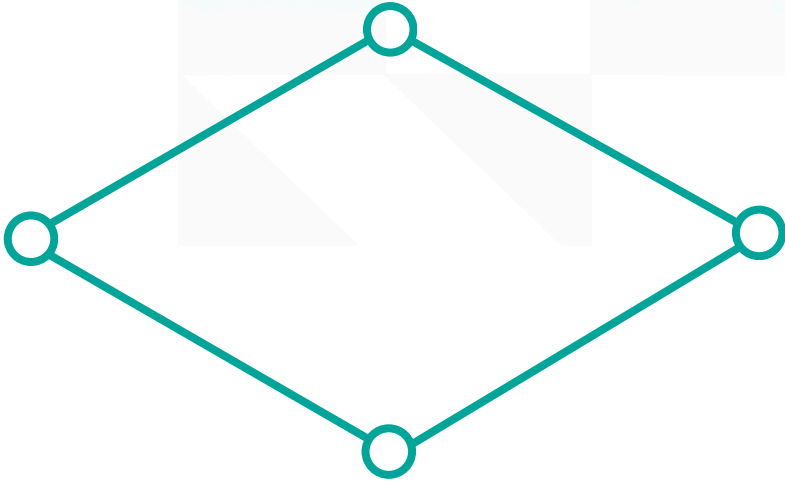

1. Mark out the outline of the platform size in the location where you will place the platform.

2



End Beam  
**Wedge Left**



End Beam  
**Wedge Right**

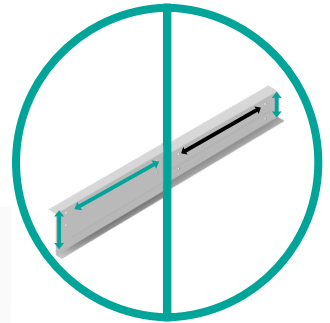
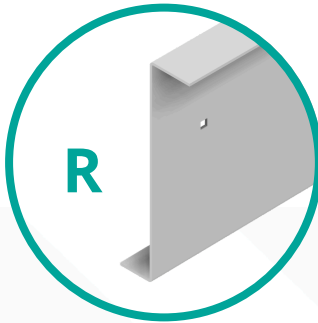
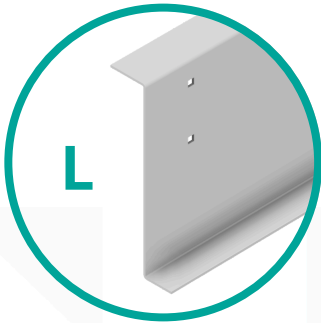

2. Place **End Beam Wedge Left** and **End Beam Wedge Right** to suit the layout. **Note** orientation of **End Beam Wedges**'. The small end can be identified by the smaller distance between end holes and/or the vertical height.

3

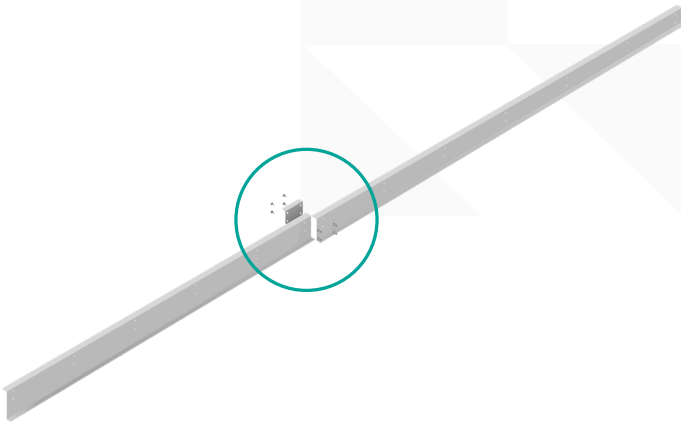

End Beam **Splice**

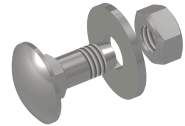

20mm **Bolts Sets**



3. If the **End Beam Wedge's** are supplied in multiple lengths they require connecting using the **End Beam Splice** and **20mm Bolt Sets**.

4

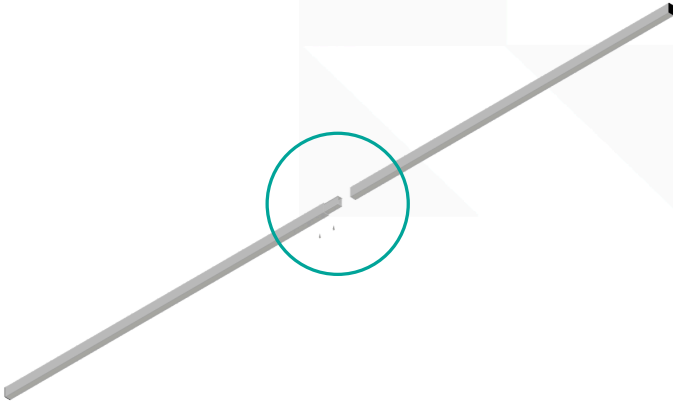

RHS  
**Splice**



20mm **Tek Screws**

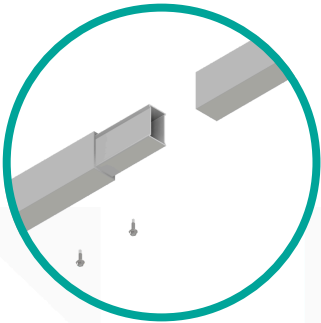

4. If the **Cross Supports** are in multiple lengths, join using **20mm Tek Screws** and the **RHS Splice**

5

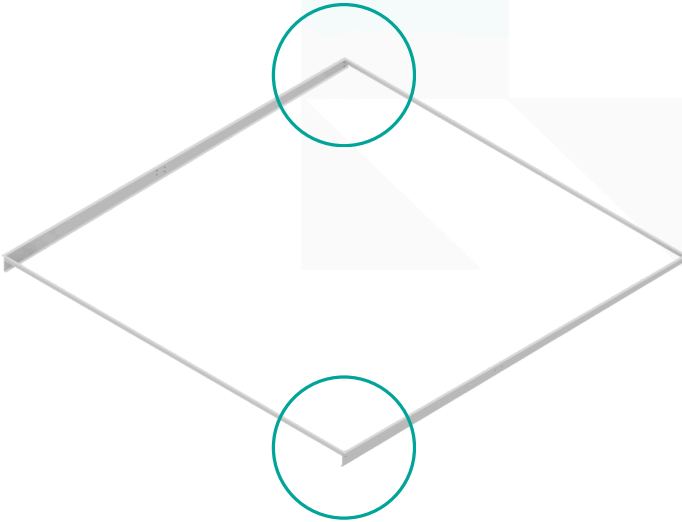

Cross **Support** with **End Bracket**



Cross Support with **End Bracing Bracket**

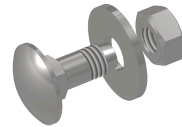

20mm **Bolt Sets**

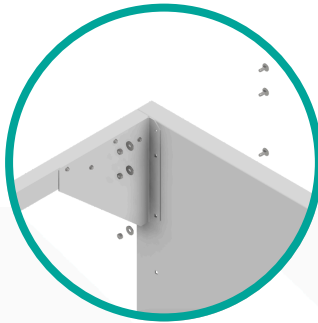
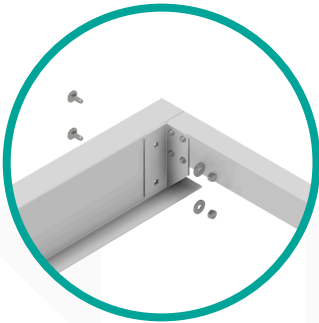

5. Place a **Cross Support** between the **End Beam Wedges** at the small end and bolt in place using **20mm Bolt Sets**. Repeat with the large end. When three holes are present, use **Cross Support with End Bracing Brackets**.

6

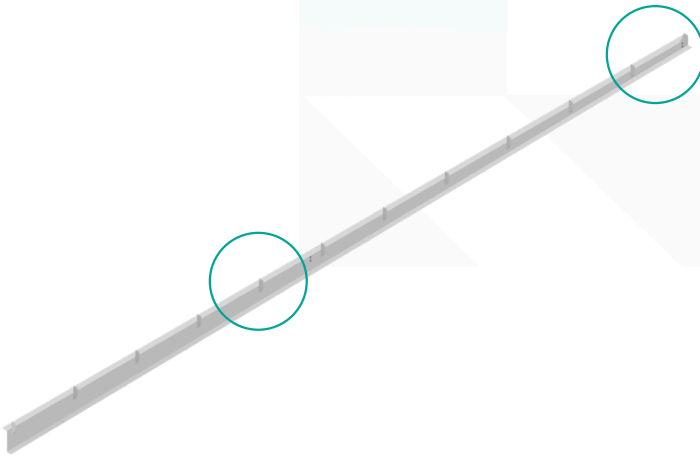

Intermediate  
**Bracket Left**



Intermediate  
**Bracket Right**



Intermediate  
**Bracing Bracket**

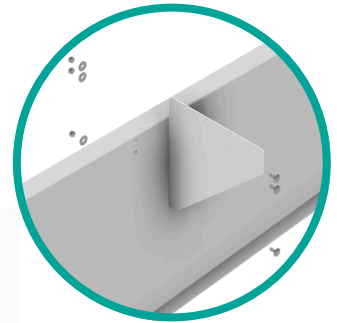
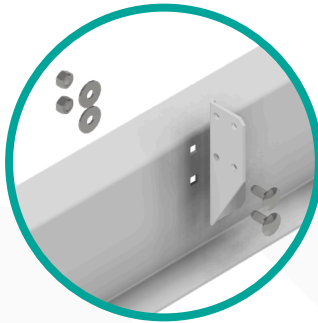

6. Prepare all the **Intermediate Wedges** by bolting an **Intermediate Bracket Left** to the small end and an **Intermediate Bracket Right** to the rest of the locations. If any of the locations have three holes then an **Intermediate Bracing Bracket** must be used.

7

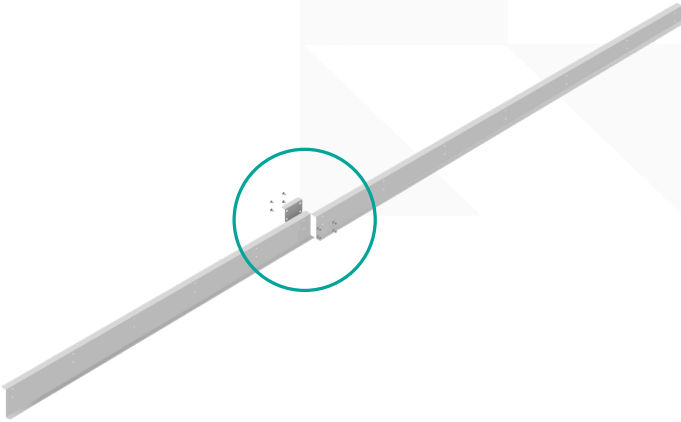

Intermediate  
**Splice**

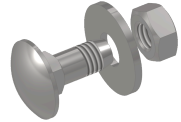

20mm **Bolts Sets**

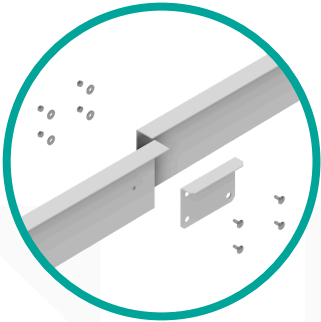

7. The **Intermediate Wedges** are supplied in multiple lengths, requiring to be connected using the **Intermediate Splice** and **20mm Bolt Sets**

8

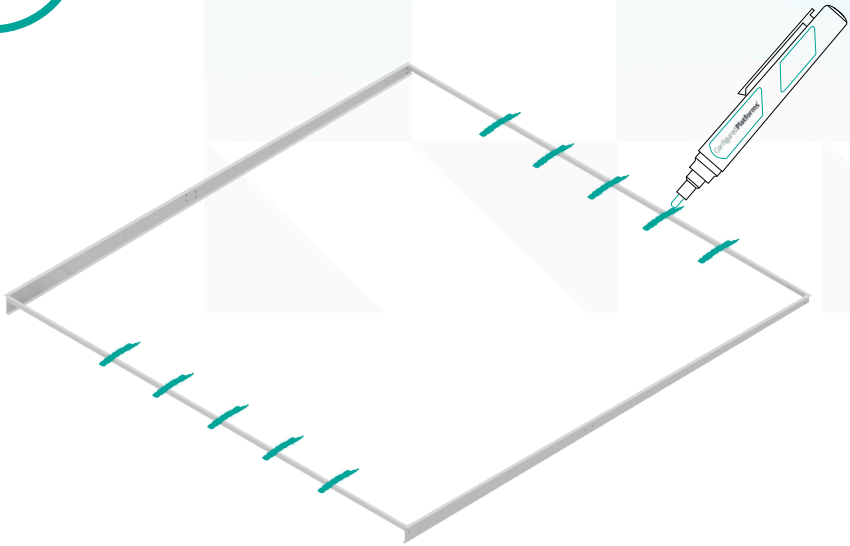

8. Mark the positions for the **Intermediate Wedges**. If positions are not noted on drawing, then **Intermediate Wedges** are equally spaced. (Number of spaces divided by length of platform). Spacing should not be greater than 1200mm unless specified.

9

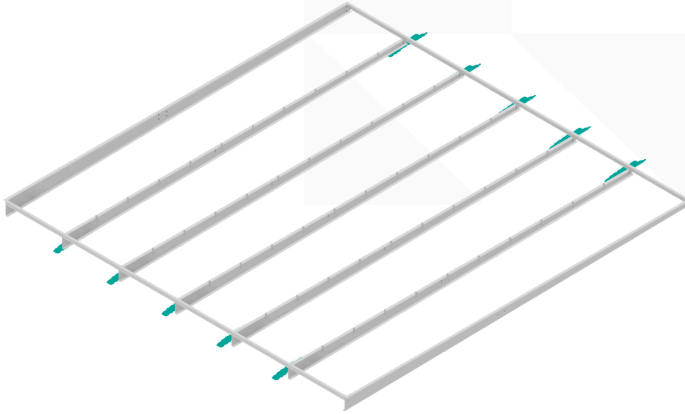

Intermediate  
**Wedge**



20mm **Tek Screws**

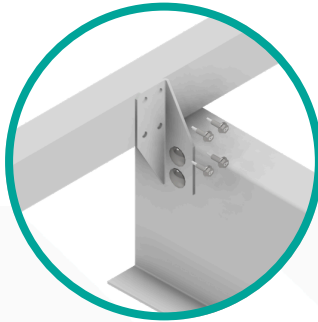
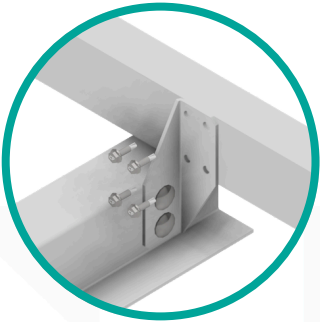

9. Place **Intermediate Wedges** in position, and fix to the **Cross Supports** using **20mm Tek Screws**, ensuring the components are held vertically plumb.

10

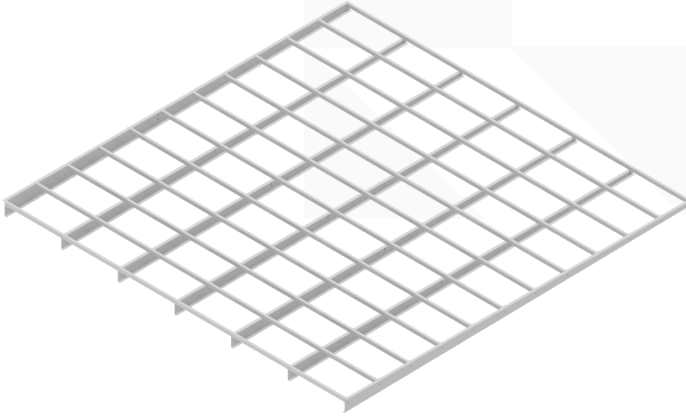

20mm **Tek** Screws

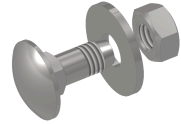

20mm **Bolts** Sets

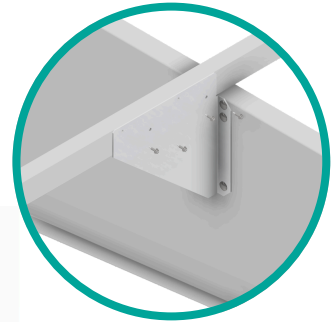
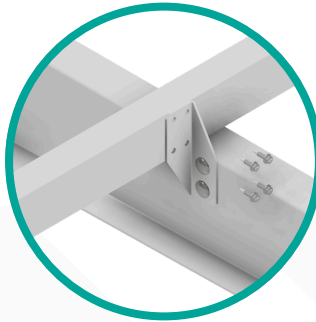

**10.** Place the rest of the **Cross Supports** in their positions with the brackets facing up towards the **small** end and fix to the **End Beam Wedges** using **20mm Bolt Sets** and to the **Intermediate Brackets Right** using **20mm Tek screws**.

11

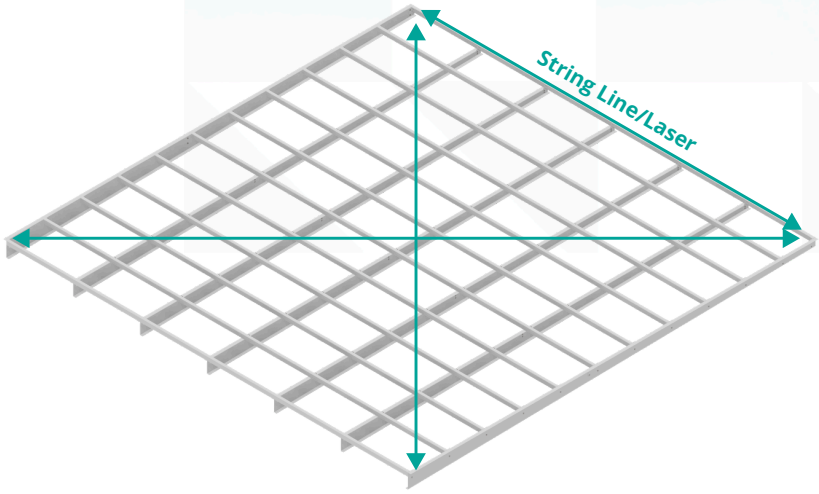

**11.** Ensure all fixings are in place and tight. Check for square using the platform's diagonal measurements and check that the frame is straight along the length by using a string line/laser.

12

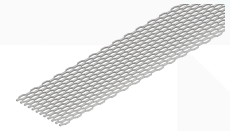
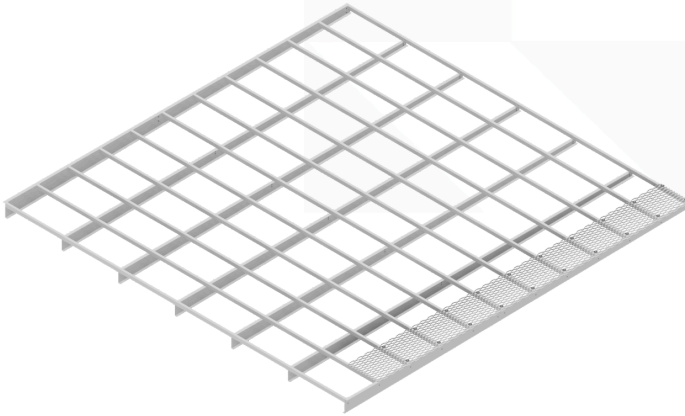

Mesh Sheet



35mm Tek Screw +  
Hold Down Disc

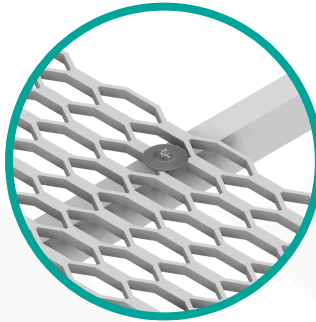
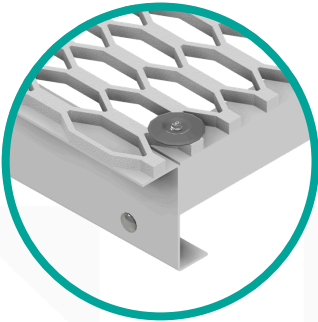

**12.** Place the **Mesh** on the **Cross Supports**, keeping it flush with the edges. Ensure the **Mesh** does not creep or run short when laid out, adjust placement before fixing. Fix **Mesh** ends using **35mm Tek Screw** with a **Hold Down Disc**, fixing to the **Cross Support** through the second full diamond of each **Mesh Sheet**.

13

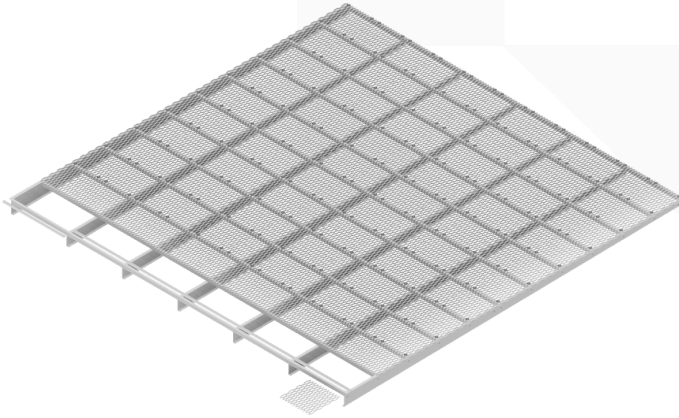

Mesh **Joiner**

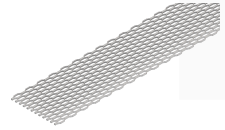

Mesh **Sheet**



35mm **Tek Screw**  
Hold Down Disc

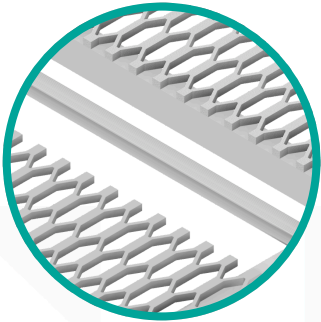

**13.** If additional rows of **Mesh** are required, fix the first row of **Mesh** down as **Step 12**. Place the end of each sheet of **Mesh** into the **Mesh Joiner** as you go, a rubber mallet can be used if required.

14

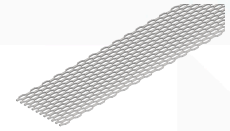
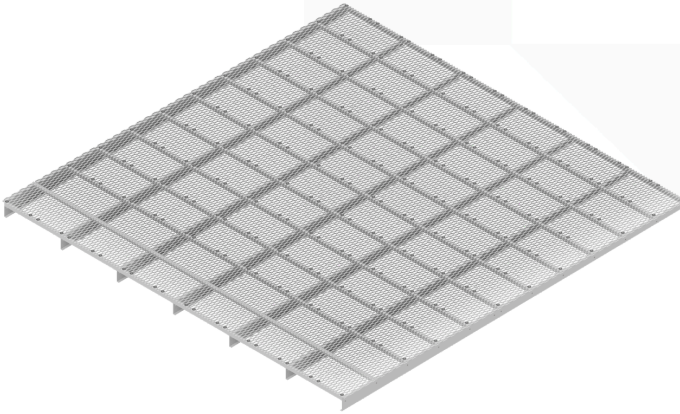

Mesh Sheet



35mm **Tek Screw** +  
Hold Down **Disc**

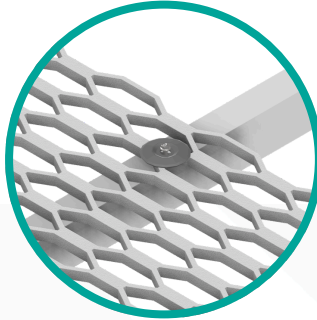
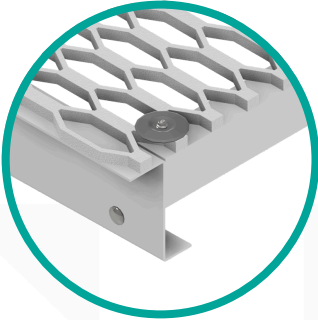

**14.** Fix the **Mesh** down in all locations where the **Mesh** is supported by Cross Supports in the second full diamond in from the edges of the **Mesh Sheet**. This will ensure two fixings at each connection.

15

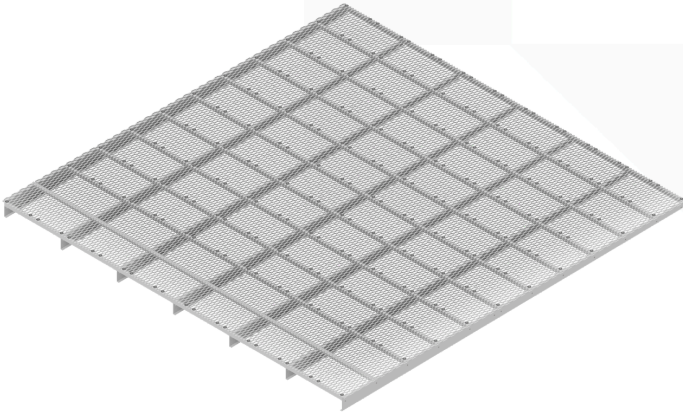

**Certification Plate**

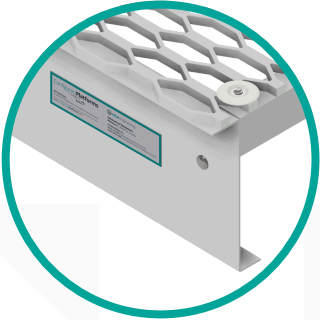

**15.** Fix the **Certification Plate** to where it is visible. Peel off the backing tape and press firmly onto the surface.